



# Test Rig and Safety Area Specifications

## Table Of Contents

- 01 Test Rig Plan View
- 02 Test Rig Elevation View
- 03 Raised Build Area CAD Details
- 04 Test Rig Safety Area Plan View
- 05 Test Rig Home Built Sample

Final Design • October 29, 2022

- Wear eye protection at all times
- Read all warnings on label before use
- Critical dimensions are in blue
- Tolerance of all parts and dimensions need to be plus or minus 1/4"

NOTES:

Test table:  
3/4" x 48" x 96" plywood with a extended 36-1/2" x 36-1/2" x 51-1/2" triangle to support fan #2 at 45°. (see page .02 for elevation details) Table surface is 30" inches off the floor.

Raised Build Area:  
3" x 36" x 36" raised platform. Plywood construction. (see page .03 for details)

Raised Build Area Grid:  
4" x 4" box grid squares are located under 1/16" smooth acrylic. Mandatory fill cell in blue. (see page .03 for details)

(2) 20" 3 Speed Industrial Fans:  
Maxx Air 20" 3 speed floor shroud fan. Fans are permanently affixed to the table surface and the fan shroud is permanently fixed at 90° to the table surface.

LINK:  
<https://www.homedepot.com/p/Maxx-Air-20-in-Floor-Shroud-Fan-H-VFF-20S-REDUPS/204409872>

NOTE:  
Anemometer wind speed measurements were taken at the front of the blue square. (see plan view page .01)

4-8 grade build-area position:  
low speed: 548 ft/min  
medium speed: 634 ft/min  
high speed: 759 ft/min

High school build-area position:  
low speed: 650 ft/min  
medium speed: 700 ft/min  
high speed: 788 ft/min

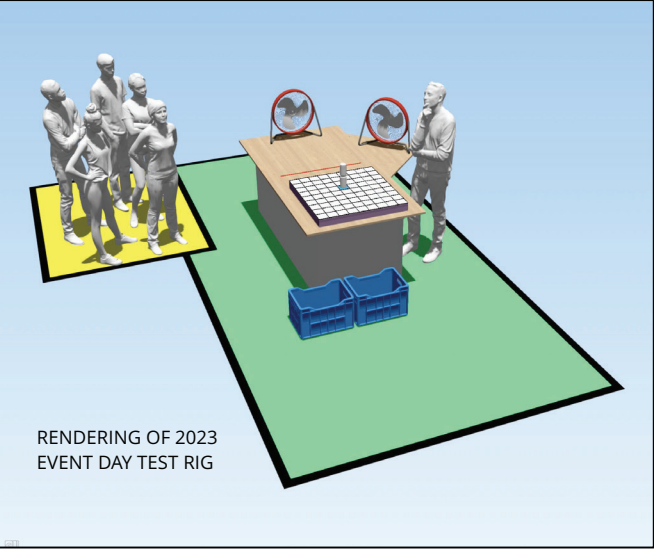

Title The Tech Interactive		
Drawing Number 00.01	Drawn By jvieira	Date 4/6/23
CAD File Name DETAIL CAD		

Copyright 2023 The Tech Interactive™  
All of the concepts, designs, and plans represented by this document are the property of TTI and are for use on the project specified in this document. No concepts, designs, or plans shall be used by any person, firm, or corporation for any purpose without the prior written permission of TTI.

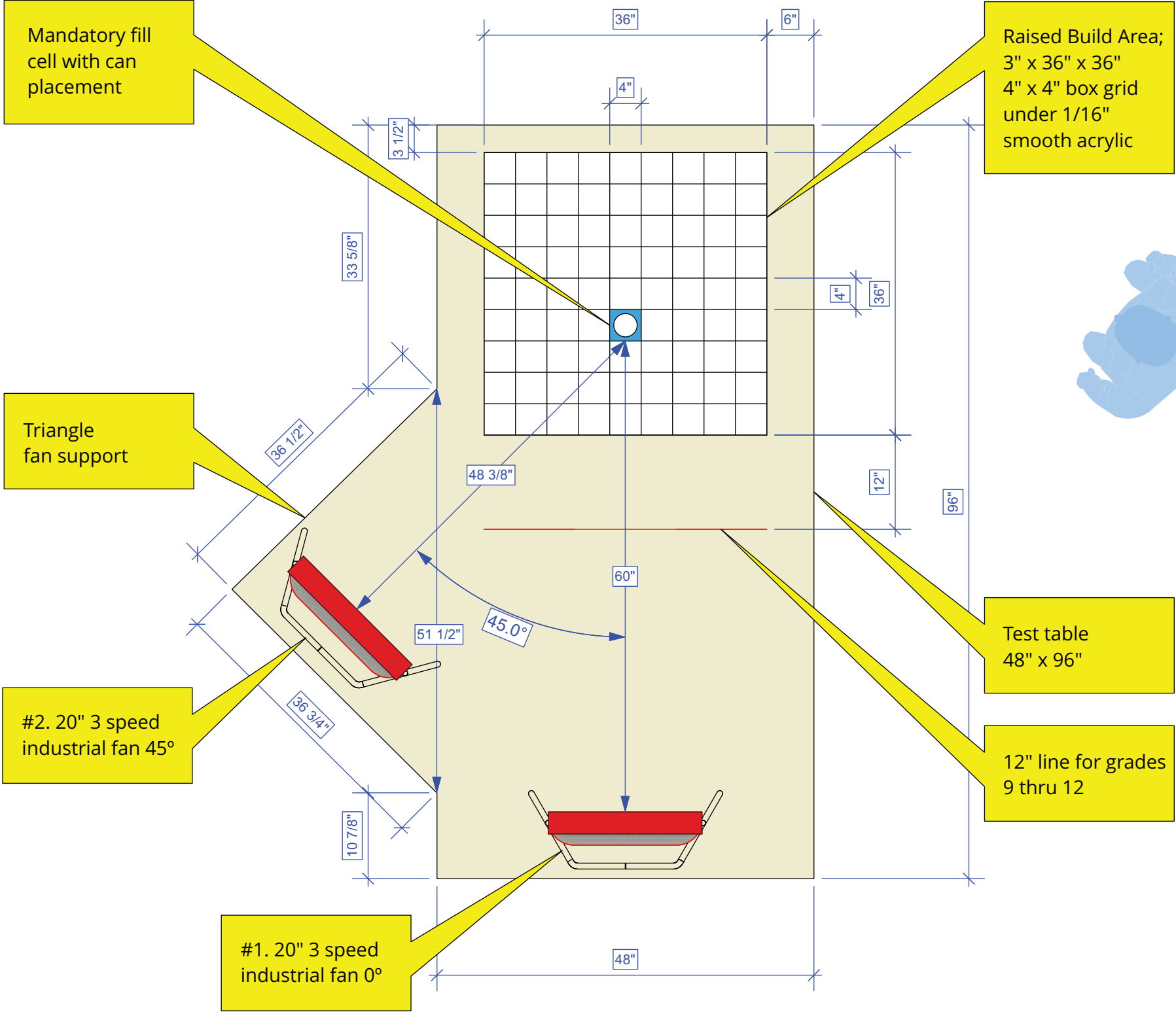

(see Survive the Storm Rule Package for additional information)

The Tech Challenge 2023 Test Rig (ONLY) Plan View

SCALE: 3/4"=1'-0"

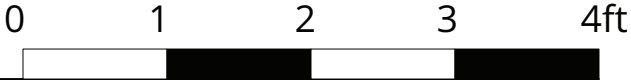

- Wear eye protection at all times
- Read all warnings on label before use
- Critical dimensions are in blue
- Tolerance of all parts and dimensions need to be plus or minus 1/4"

NOTES:

Test table:  
3/4" x 48" x 96" plywood with a extended 36-1/2" x 36-1/2" x 51-1/2" triangle to support fan #2 at 45°. (see page .02 for elevation details) Table surface is 30" inches off the floor.

Raised Build Area:  
3" x 36" x 36" raised platform. Plywood construction. (see page .03 for details)

Raised Build Area Grid:  
4" x 4" box grid squares are located under 1/16" smooth acrylic. Mandatory fill cell in blue. (see page .03 for details)

(2) 20" 3 Speed Industrial Fans:  
Maxx Air 20" 3 speed floor shroud fan. Fans are permanently affixed to the table surface and the fan shroud is permanently fixed at 90° to the table surface.

LINK:  
<https://www.homedepot.com/p/Maxx-Air-20-in-Floor-Shroud-Fan-H-VFF-20S-REDUPS/204409872>

NOTE:  
Anemometer wind speed measurements were taken at the front of the blue square. (see plan view page .01)

4-8 grade build-area position:  
low speed: 548 ft/min  
medium speed: 634 ft/min  
high speed: 759 ft/min

High school build-area position:  
low speed: 650 ft/min  
medium speed: 700 ft/min  
high speed: 788 ft/min

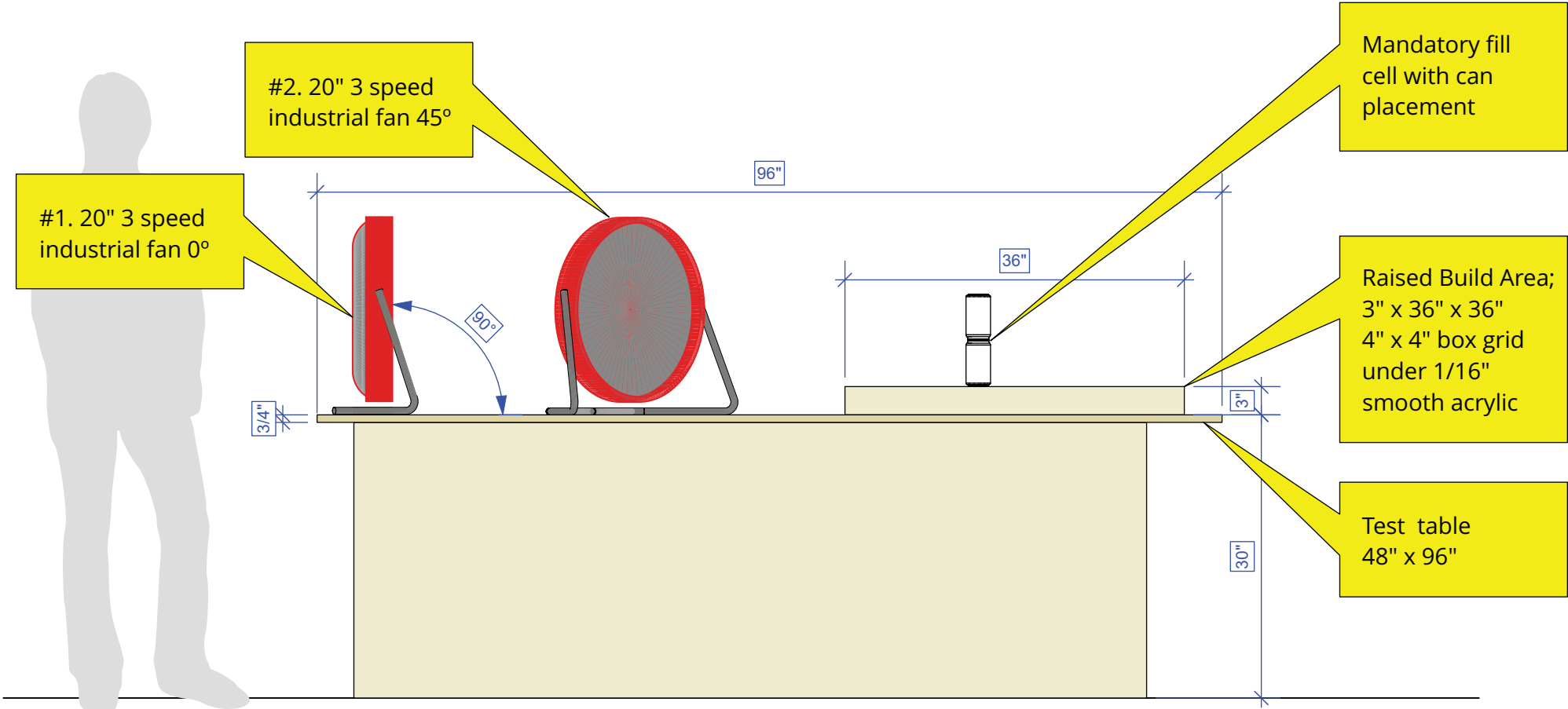

(see Survive the Storm Rule Package for additional information)

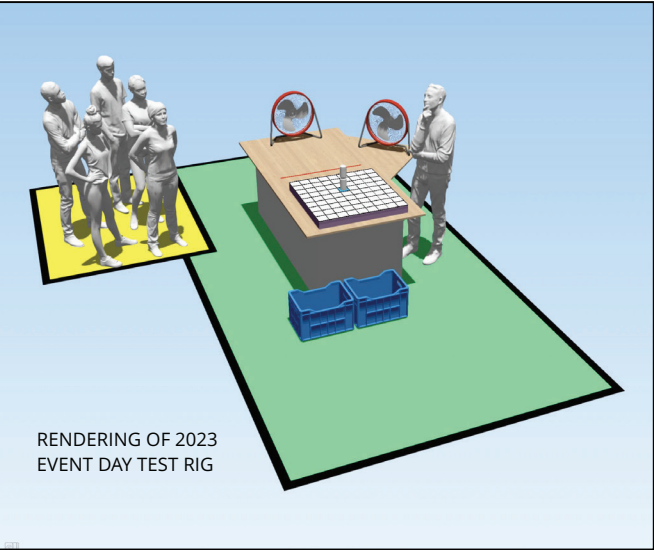

The Tech Challenge 2023    Test Rig (ONLY)    Elevation View

SCALE: 3/4"=1'-0"

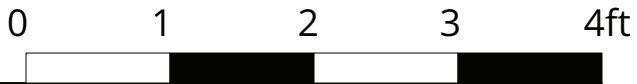

Title The Tech Interactive			Copyright 2023 The Tech Interactive™
Drawing Number 00.02	Drawn By jvieira	Date 4/6/23	All of the concepts, designs, and plans represented by this document are the property of TTI and are for use on the project specified in this document. No concepts, designs, or plans shall be used by any person, firm, or corporation for any purpose without the prior written permission of TTI.
CAD File Name DETAIL CAD			

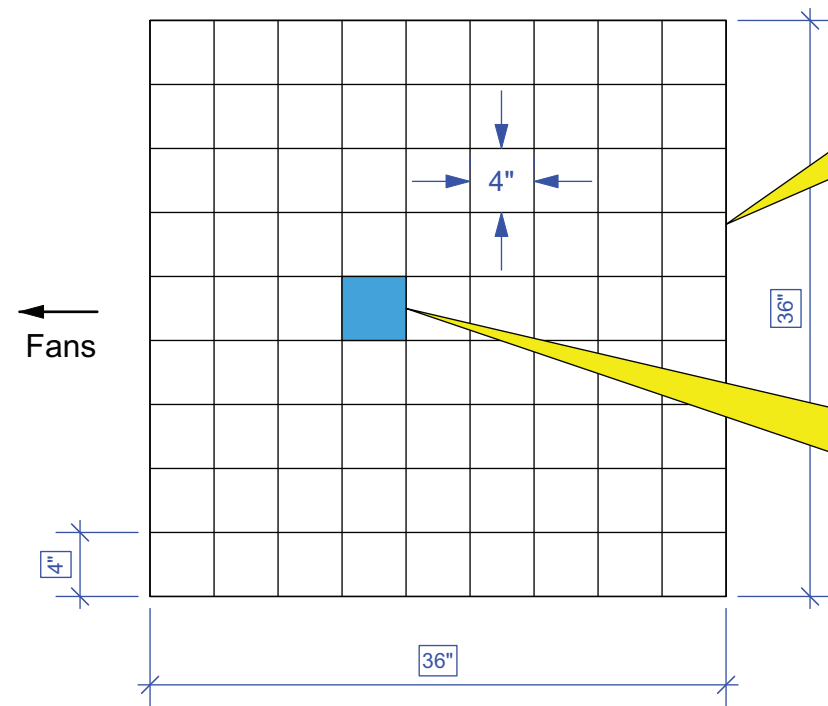

Plan View

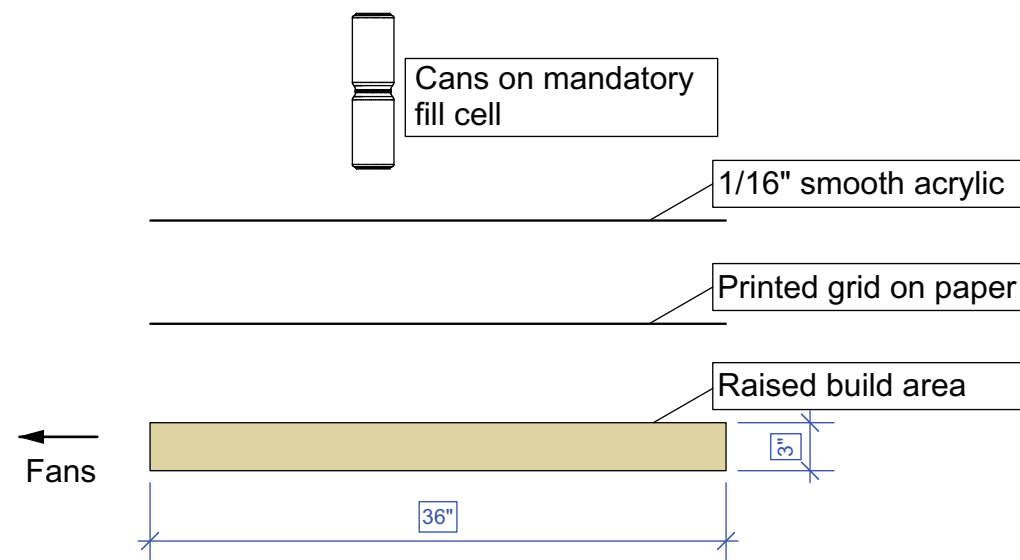

Side View

Raised Build Area;  
3" x 36" x 36"  
4" x 4" box grid  
under 1/16"  
smooth acrylic

Mandatory fill  
cell with can  
placement

Smooth Acrylic  
1/16" x 36" x 36"

Printed grid  
on paper

Raised Build Are  
3" x 36" x 36"

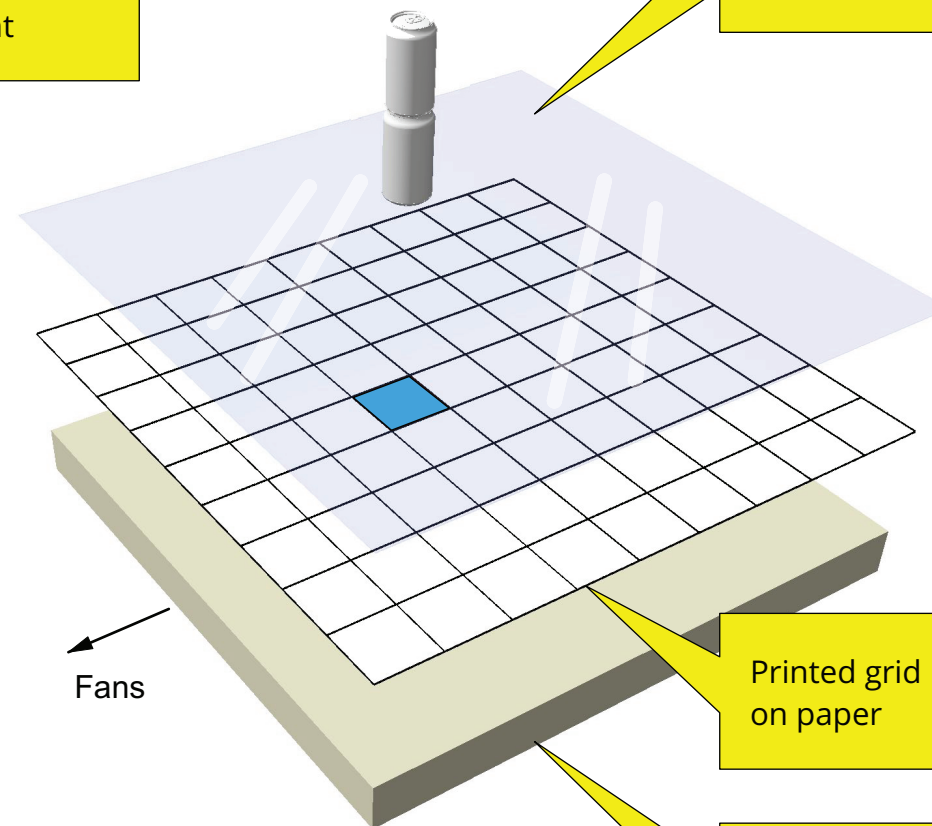

Perspective View

(see Survive the Storm Rule Package  
for additional information)

- Wear eye protection at all times
- Read all warnings on label before use
- Critical dimensions are in blue
- Tolerance of all parts and dimensions need to be plus or minus 1/4"

#### NOTES:

##### Test table:

3/4" x 48" x 96" plywood with a extended 36-1/2" x 36-1/2" x 51-1/2" triangle to support fan #2 at 45°. (see page .02 for elevation details) Table surface is 30" inches off the floor.

##### Raised Build Area:

3" x 36" x 36" raised platform. Plywood construction. (see page .03 for details)

##### Raised Build Area Grid:

4" x 4" box grid squares are located under 1/16" smooth acrylic. Mandatory fill cell in blue. (see page .03 for details) (see page .03 for details)

##### (2) 20" 3 Speed Industrial Fans:

Maxx Air 20" 3 speed floor shroud fan. Fans are permanently affixed to the table surface and the fan shroud is permanently fixed at 90° to the table surface.

##### LINK:

<https://www.homedepot.com/p/Maxx-Air-20-in-Floor-Shroud-Fan-H-VFF-20S-REDUPS/204409872>

##### NOTE:

Anemometer wind speed measurements were taken at the front of the blue square. (see plan view page .01)

##### 4-8 grade build-area position:

low speed: 548 ft/min  
medium speed: 634 ft/min  
high speed: 759 ft/min

##### High school build-area position:

low speed: 650 ft/min  
medium speed: 700 ft/min  
high speed: 788 ft/min

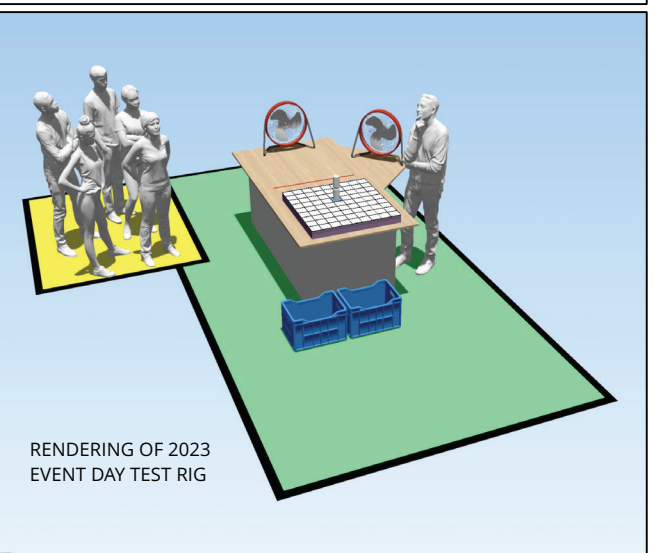

## The Tech Challenge 2023 Raised Build Area Assorted Views

SCALE: 1"=1'-0"

Title The Tech Interactive		
Drawing Number 00.03	Drawn By jvieira	Date 4/6/23
CAD File Name DETAIL CAD		

Copyright 2023 The Tech Interactive™  
All of the concepts, designs, and plans represented by this document are the property of TTI and are for use on the project specified in this document. No concepts, designs, or plans shall be used by any person, firm, or corporation for any purpose without the prior written permission of TTI.

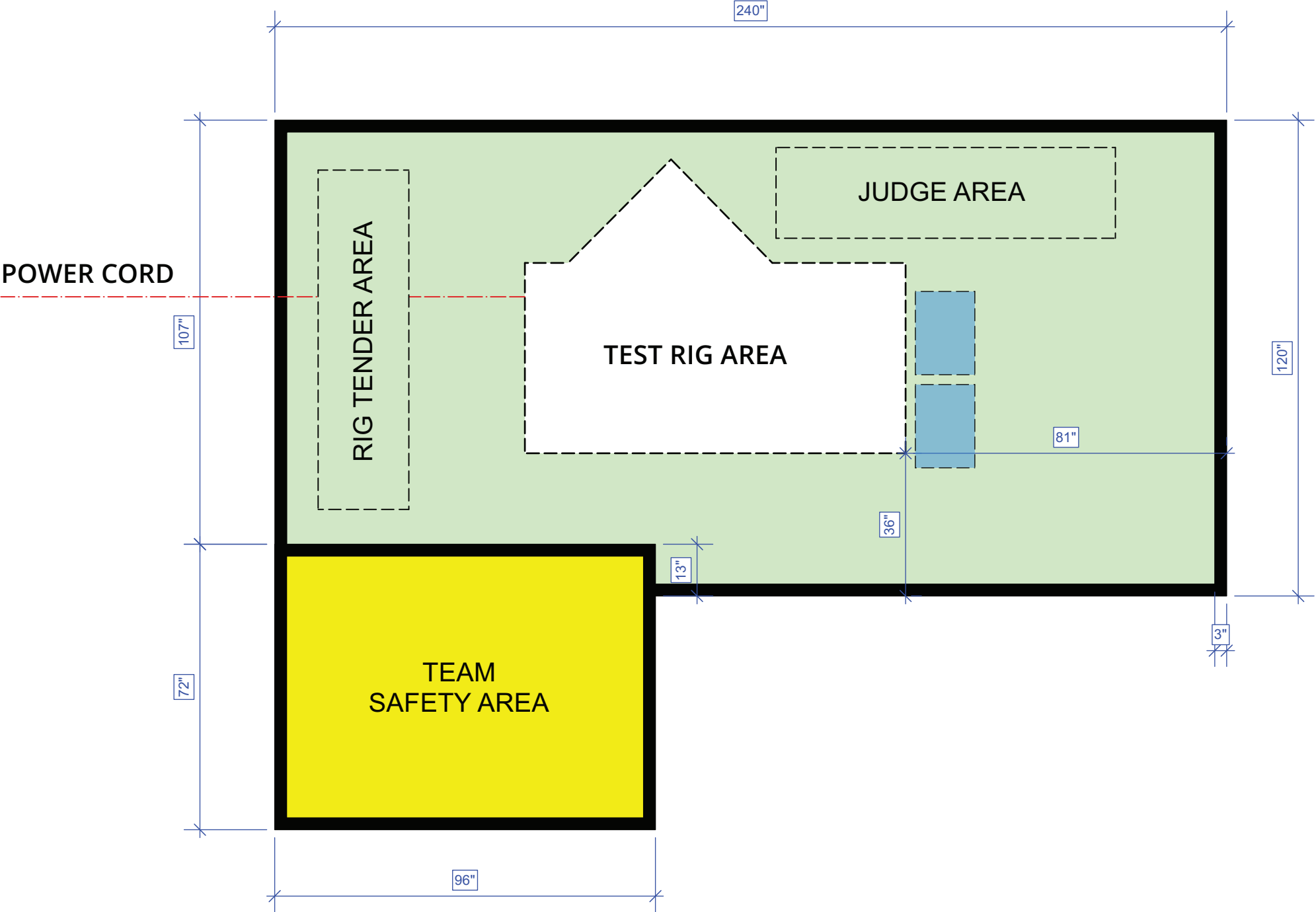

- Wear eye protection at all times
- Read all warnings on label before use
- Critical dimensions are in blue
- Tolerance of all parts and dimensions need to be plus or minus 1/4"

NOTES:

Test table:  
3/4" x 48" x 96" plywood with a extended 36-1/2" x 36-1/2" x 51-1/2" triangle to support fan #2 at 45°. (see page .02 for elevation details) Table surface is 30" inches off the floor.

Raised Build Area:  
3" x 36" x 36" raised platform. Plywood construction. (see page .03 for details)

Raised Build Area Grid:  
4" x 4" box grid squares are located under 1/16" smooth acrylic. Mandatory fill cell in blue. (see page .03 for details)

(2) 20" 3 Speed Industrial Fans:  
Maxx Air 20" 3 speed floor shroud fan. Fans are permanently affixed to the table surface and the fan shroud is permanently fixed at 90° to the table surface.

LINK:  
<https://www.homedepot.com/p/Maxx-Air-20-in-Floor-Shroud-Fan-H-VFF-20S-REDUPS/204409872>

NOTE:  
Anemometer wind speed measurements were taken at the front of the blue square. (see plan view page .01)

4-8 grade build-area position:  
low speed: 548 ft/min  
medium speed: 634 ft/min  
high speed: 759 ft/min

High school build-area position:  
low speed: 650 ft/min  
medium speed: 700 ft/min  
high speed: 788 ft/min

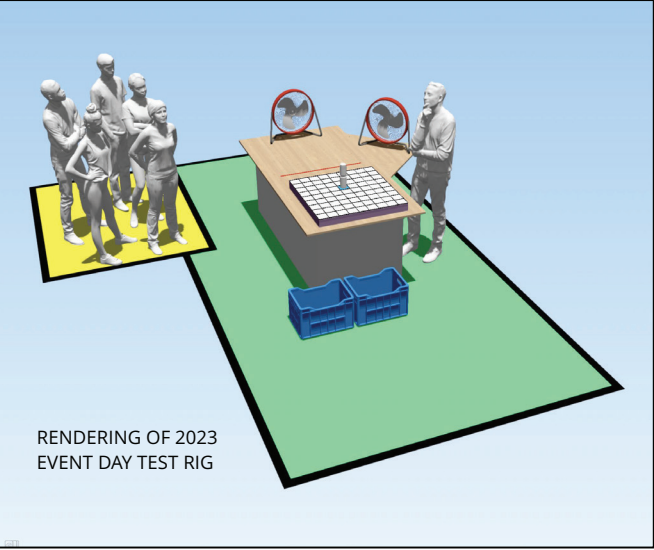

RENDERING OF 2023  
EVENT DAY TEST RIG

The Tech Challenge 2023 Safety Area Plan View

SCALE: 3/4"=1'-0"

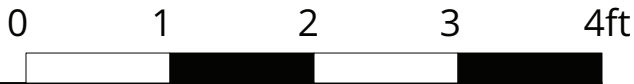

(see Survive the Storm Rule Package  
for additional information)

Title The Tech Interactive		
Drawing Number 00.04	Drawn By jvieira	Date 4/6/23
CAD File Name DETAIL CAD		

Copyright 2023 The Tech Interactive™  
All of the concepts, designs, and plans represented by this document are the property of TTI and are for use on the project specified in this document. No concepts, designs, or plans shall be used by any person, firm, or corporation for any purpose without the prior written permission of TTI.



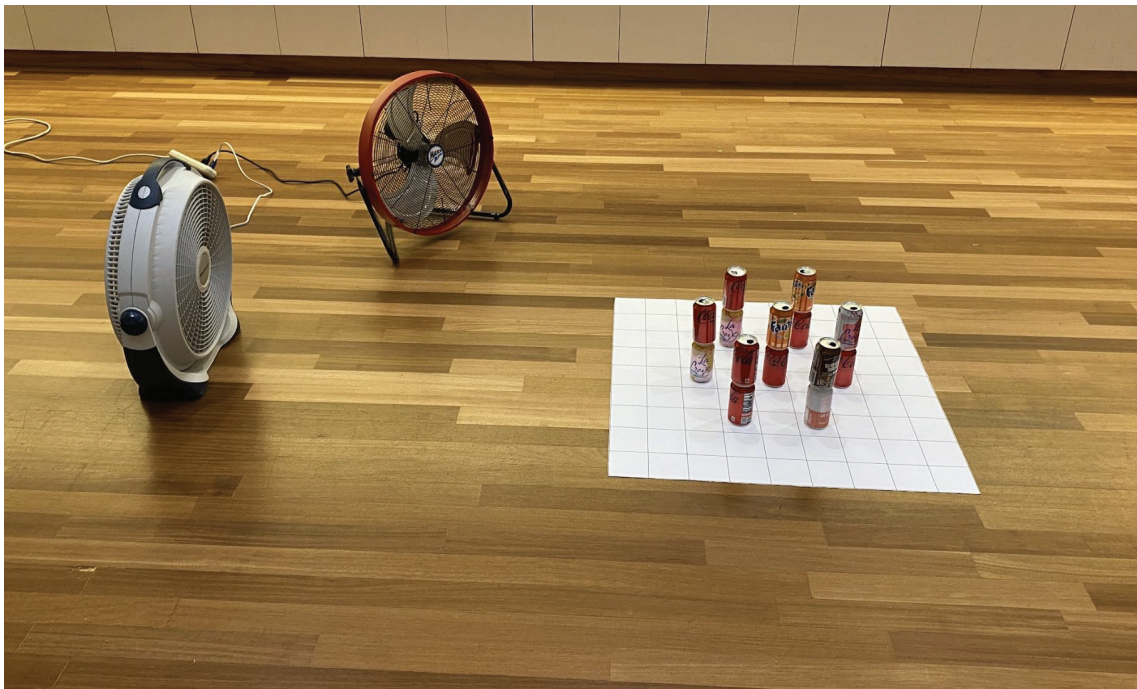
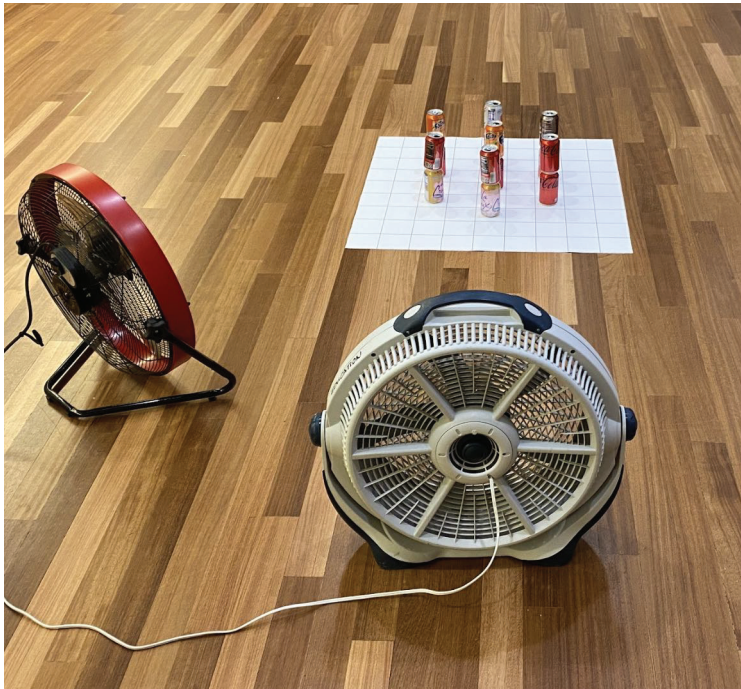

Sample of home built test area

(see Survive the Storm Rule Package for additional information)

- Wear eye protection at all times
- Read all warnings on label before use
- Critical dimensions are in blue
- Tolerance of all parts and dimensions need to be plus or minus 1/4"

NOTES:

Test table:  
3/4" x 48" x 96" plywood with a extended 36-1/2" x 36-1/2" x 51-1/2" triangle to support fan #2 at 45°. (see page .02 for elevation details) Table surface is 30" inches off the floor.

Raised Build Area:  
3" x 36" x 36" raised platform. Plywood construction. (see page .03 for details)

Raised Build Area Grid:  
4" x 4" box grid squares are located under 1/16" smooth acrylic. Mandatory fill cell in blue. (see page .03 for details)

(2) 20" 3 Speed Industrial Fans:  
Maxx Air 20" 3 speed floor shroud fan. Fans are permanently affixed to the table surface and the fan shroud is permanently fixed at 90° to the table surface.

LINK:  
<https://www.homedepot.com/p/Maxx-Air-20-in-Floor-Shroud-Fan-H-VFF-20S-REDUPS/204409872>

NOTE:  
Anemometer wind speed measurements were taken at the front of the blue square. (see plan view page .01)

4-8 grade build-area position:  
low speed: 548 ft/min  
medium speed: 634 ft/min  
high speed: 759 ft/min

High school build-area position:  
low speed: 650 ft/min  
medium speed: 700 ft/min  
high speed: 788 ft/min

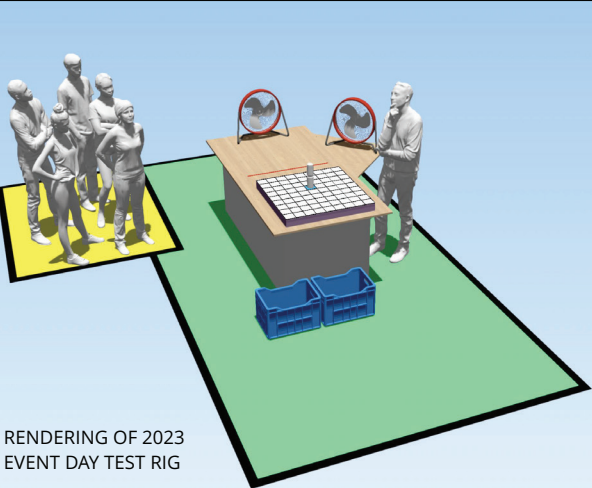

RENDERING OF 2023  
EVENT DAY TEST RIG

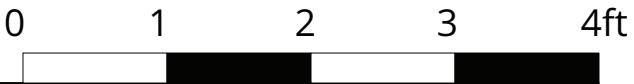

Title The Tech Interactive		
Drawing Number 00.05	Drawn By jvieira	Date 4/6/23
CAD File Name DETAIL CAD		

Copyright 2023 The Tech Interactive™  
All of the concepts, designs, and plans represented by this document are the property of TTI and are for use on the project specified in this document. No concepts, designs, or plans shall be used by any person, firm, or corporation for any purpose without the prior written permission of TTI.